

INSTRUCTIONS FOR USE

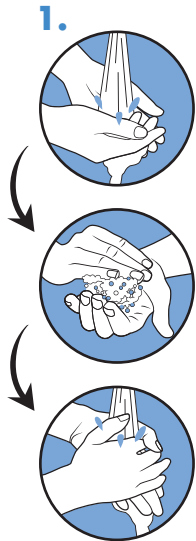

1. Wash first your hands carefully, with water and soap :
Follow these five steps every time.
 - a. **Wet** your hands with clean, running water (warm or cold), turn off the tap, and apply soap.
 - b. **Lather** your hands by rubbing them together with the soap. Lather the backs of your hands, between your fingers, and under your nails.
 - c. **Scrub** your hands for at least 20 seconds. Need a timer? Hum the "Happy Birthday" song from beginning to end twice.
 - d. **Rinse** your hands well under clean, running water.
 - e. **Dry** your hands using a clean towel or air dry them.

Disinfecting hands is an option, if hands are not specifically dirty (hydroalcoholic lotion or equivalent).

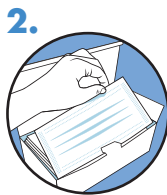

2. Open the box, remove a single mask from the packaging by **holding the side** of the mask.
Close the box for hygienic storage.



3. Hold the mask flat in front of you. This way you can easily **pull the lower elastic** and hold the mask to the chin whilst bringing the 1st headband over your head. **The nose bar should be on top.**



4. Bring the **lower elastic** over the head and position it at the **back of the neck** in line with the chin. That way the mask is already quite well positioned in front of the face.



5. First **open the folds** of the mask and hold it under your chin to keep the protective part in place in front of your mouth.



6. Then bring the **2nd elastic over the head**, in maintaining the protective surface in your mouth, and position it towards the crown of the head.



7. **Adjust** again first elastic in the neck (if needed).



8. **Adjust the nose-wire** to squeeze the mask around the nose and to fully close the top part.



9. The mask should be disposed **any time you remove it**, if it gets **dirty** and certainly **after 4 hours** of continuous use.



- Remove the mask by using both thumbs, **starting with the lower elastic** in the neck. At ear level, the **upper elastic will automatically come together** and both will be removed at the same time. During that time, the protective part of the mask remains positioned on your mouth.



- Try not to hold/touch the outer layer of the mask as this could be contaminated and your hand may come in to contact with your face.



- Do not remove the mask by pulling the protective surface to the top of your head (to avoid any face / eyes contamination)



10. Once removed, dispose of the mask **in a waste bag** and a bin, then **wash** again your hands as explained in step 1.



- Disinfecting hands is an option**, if hands are not specifically dirty (hydroalcoholic lotion or equivalent).